



LZ 15X12





Accessories			
	conf.	package	EAN
8819 - grommet			
	HB	10	8595057612679
intended for transition to the LK 80X28 trunking box			
8824/41 - transition branching			
	HB	10	8595057612693
intended for transition to the LP 80X25 trunking			

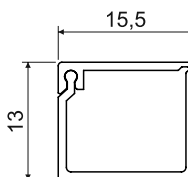

MAT
⊃
⊃
⊃
⊃
⊃
⊃
⊃
⊃
⊃

PVC -5 - +60°C 850°C A1 - F 30 sec. 0,5 J 140 mm² Pb Free IP 30

✓ One side of the lid is a part of the trunking body, the second side of the lid can be simply snapped on, it is fitted with double lock increasing the trunking's rigidity and ensuring stronger cover fixation.

conf.		L			EAN	note
		m	m			
HA	white	3	60	folie	8595057611153	
HD	white	2	96	carton	8595057612426	
KA	light grey	3	60	folie	8595057612259	
KD	light grey	2	96	carton	8595057656475	

