

LHD 20X20

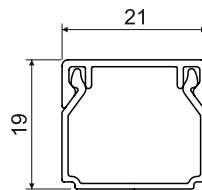

MAT
Temperature: -5 - +60°C
Fire: 850°C
Flame: A1 - F
Time: 30 sec.
Impact: 0,5 J
Area: 260 mm<sup>2</sup>
Pb Free
Explosion: 
IP: IP 40
IK: IK06

- Standard shape.
- Designed for wall or ceiling mounting.
- Double lock on lid increasing the trunking's rigidity and ensuring stronger cover fixation.

conf.	color	L		description	EAN	note
		m	m			
HA	white	3	147	folie	8595057608870	without protective foil
HD	white	2	48	carton	8595057609617	with protective foil
P2	white	2	48	carton	8595057691025	self-adhesive tape
I1	pink birch	2	24	carton	8595057656659	
I2	dark oak	2	24	carton	8595057656666	
SD	light wood	2	48	carton	8595568903044	
TD	dark wood	2	48	carton	8595568903051	



Accessories			
	conf.	package	EAN
<b>8621 - end</b>			
	HB	10	8595057609754
	I1	1	8595057656734
	I2	1	8595057656741
	SD	1	8595568909220
<b>8622 - connecting</b>			
	HB	10	8595057609778
	I1	1	8595057656758
	I2	1	8595057656765
	SD	1	8595568905437
<b>8623 - bending</b>			
	HB	10	8595057610941
	I1	1	8595057656772
	I2	1	8595057656789
	SD	1	8595568910318
<b>8624 - branching</b>			
	HB	10	8595057610552
	I1	1	8595057656796
	I2	1	8595057656802
	SD	1	8595057610552
<b>8625 - inner corner</b>			
	HB	10	8595057611825
	I1	1	8595057656826
	I2	1	8595057656833
	SD	1	8595568910332
<b>8626 - outer corner</b>			
	HB	10	8595057611214
	I1	1	8595057656840
	I2	1	8595057656857
	SD	1	8595568910349
<b>8629 - grommet</b>			
	HB	10	8595057608535
	I1	1	8595568909060
	I2	1	8595568909091
	SD	1	8595568909121
	intended for transition to the LK 80X28 trunking box		
<b>8824/12 - transition branching</b>			
	HB	10	8595057611252
	intended for transition to the LP 80X25 trunking		